

# shade aide®



## HMI Protection - See the *Difference*

Look for your HMI model on our compatibility page to find out what **SHADE AIDE®** you need.

## NEW MODELS



MODIFIED MINI



SQUARE MINI



MEDIUM

## AND MORE!



Smith & Loveless Inc.



## SIZES & COLORS

Built for rugged industrial environments, the **SHADE AIDE®** is sure to fit your HMI whether that is in inches or metric measurements. We'll even customize the **SHADE AIDE®** to your specific HMI size, color, and logo. Select your **SHADE AIDE®** below.



### Select Your Maximum HMI Area

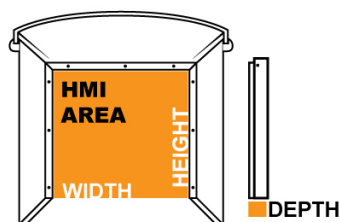

#### 1). Mini Screen

5" W x 2.875" H  
127mm W x 73mm H

#### 2). Modified Mini Screen

5.75" W x 3.75" H  
147mm W x 96mm H

#### 3). Square Mini Screen

7" W x 7" H  
178mm W x 178mm H

#### 4). Mini Tall

5" W x 12" H  
127mm W x 305mm H

#### 5). Small Screen

9.875" W x 7.25" H  
251mm W x 184mm H

#### 6). Medium Screen

12" W x 9" H  
305mm W x 229mm H

#### 7). Large Screen

15.875" W x 11.25" H  
403mm W x 286mm H

#### 8). Large Deep Screen

15.875" W x 11.25" H x 2" D  
403mm W x 286mm H x  
50mm D

#### 9). Square Large Screen

11.5" W x 11.5" H  
293mm W x 293mm H

#### 10). Large Modified Screen

13.875" W x 11.25" H  
385mm W x 286mm H

#### 11). XLarge Screen

19.875" W x 14.25" H  
505mm W x 362mm H

#### 12). XLarge Modified Screen

17" W x 14.25" H  
432mm W x 362mm H x  
26mm D

#### 13). XLarge XTall Screen

19.875" W x 18.25" H  
505mm W x 464mm H

#### 14). XLarge Long Screen

22.5" W x 14.25" H  
565mm W x 362mm H

#### 15). XLarge High Speed Screen

19.875" W x 18.25" H  
505mm W x 464mm H

#### 16). Mega Screen

28.937" W x 24.75" H  
735mm W x 629mm H x  
381mm D

#### 17). MEGA Shallow Screen

28.937" W x 24.75" H  
735mm W x 629mm H

#### 18). MEGA Shallow High Speed Screen

28.937" W x 24.75" H  
735mm W x 629mm H

#### 19). Custom

Any Size, Any Color + SST

### NEMA 4

### NEMA 4X

Or order in the custom color of your choice!

#### Powder Coated Aluminum



Black



White



Grey

#### SST



SST

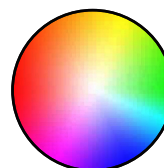

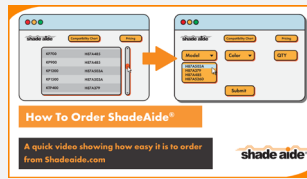

# VIDEOS

Check out our **SHADE AIDE®** videos to see our different sizing and color options, cool features, how to install it and more at [ShadeAide.com](http://ShadeAide.com)!

# NEW MODELS

**SHADE AIDE®** is proud to offer an expanded line of products to keep you covered no matter the application. Check out our website for our constantly improving line of products for all of your shady needs.

## SHADE AIDE® MINI SCREEN

Just because your screens are small, doesn't mean they don't need protection from the sun.

**Mini Screen**  
5" W x 2.875" H  
127mm W x 73mm H



## SHADE AIDE® SQUARE MINI

This 7" x 7" square **SHADE AIDE®** has a ton of applications. This specific size is often used as the standard HMI size.

**Square Mini Screen**  
7" W x 7" H  
178mm W x 178mm H



## SHADE AIDE® MODIFIED MINI

The New Modified Mini **SHADE AIDE®** protects many 3.5" HMI displays with its 5.75" W x 3.75" H size.

### Modified Mini Screen

5.75" W x 3.75" H  
147mm W x 96mm H



## SHADE AIDE® MINI TALL

The Mini-Tall is customizable and, like all models, can have your logo added.

### Mini Tall

5" W x 12" H  
127mm W x 305mm H

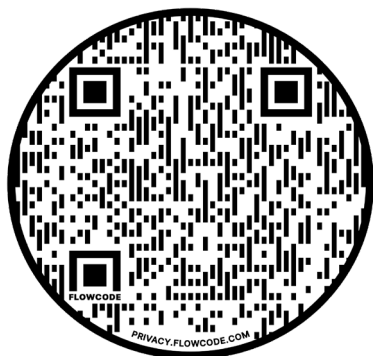

## AND MORE!

Check out our other models that will fit your specific need or order a custom size for your unique application.

# NEW MODELS CONT.



## SHADE AIDE® MEDIUM SCREEN

With its easy-to-use design and snug fit, this medium-sized **SHADE AIDE®** is the ideal choice for anyone looking to keep their HMI screen in top condition.

**Medium Screen**  
12" W x 9" H  
305mm W x 229mm H

## SHADE AIDE® SQUARE LARGE

Whether you need to protect your screen from the elements or want to keep it looking its best, our square HMI cover is the perfect choice.

**Square Large Screen**  
11.5" W x 11.5" H  
293mm W x 293mm H





# EASY INSTALLATION

Step 1: Mark holes

Step 2: Drill holes

Step 3: Install **SHADE AIDE®**

Step 4: Test opening and closing

YOU NOW HAVE  
*INSTANT* SHADE.

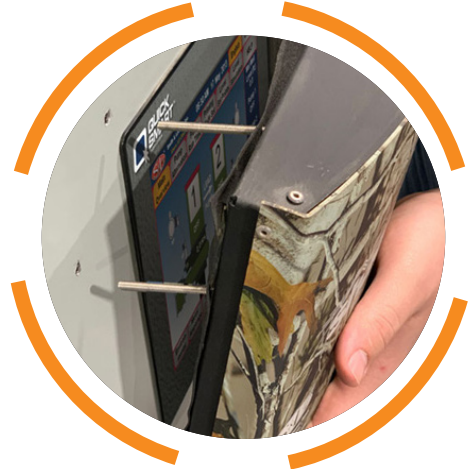

# COMPATIBILITY

Find the right **SHADE AIDE®** for you. The **SHADE AIDE®** HMI Protector is compatible with many different HMI screens. Just look up your HMI manufacturer and find the **SHADE AIDE®** model that is compatible. No need to look at a standard, one-size-fits-all options.



See all compatibility charts  
online at [shadeaide.com](http://shadeaide.com)!

You asked. We heard. Your  
favorite **SHADE AIDE®** now  
has UL and CUL listing.

Follow us on social media  
for the latest updates!

